

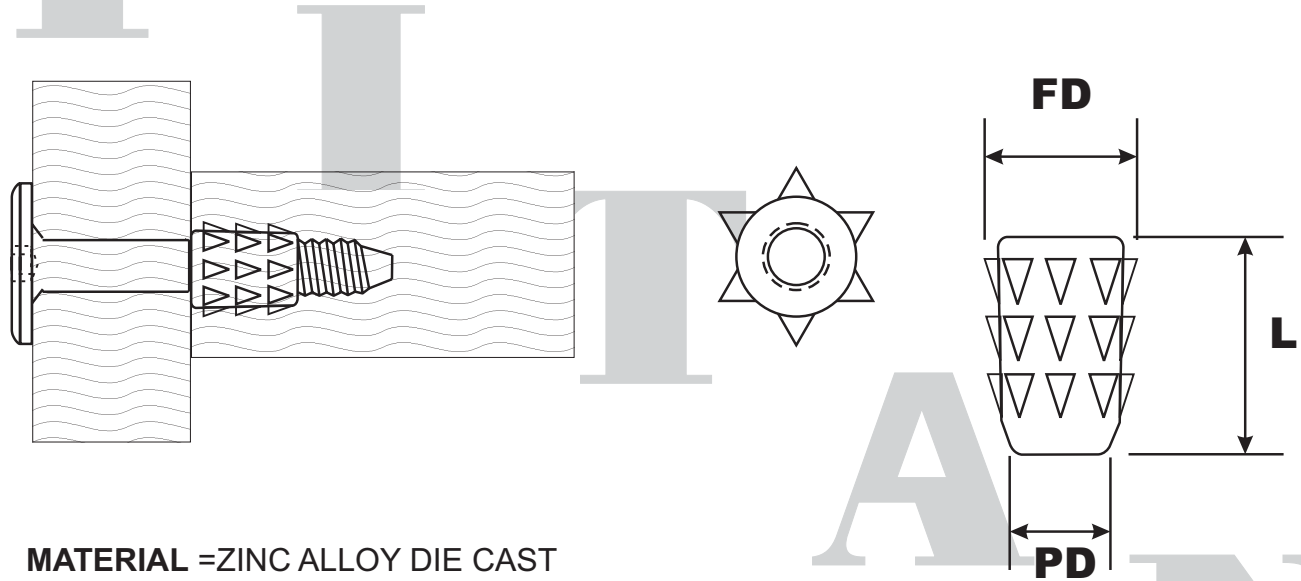

**TITAN**  
**HARDWARE INTERNATIONAL**  
 7711 AMIGOS AVE, SUITE C, DOWNEY, CA 90242  
 LOCAL PH 562-803-1695 FAX 562-803-6605  
 EMAIL SALES@TITANHARDWARE.COM

# TYPE "A" INSERT

## (KNOCK IN)



**MATERIAL =ZINC ALLOY DIE CAST**

**TYPE "A" INSERTS** ARE THE HIGH QUALITY- LOW COST ALTERNATIVE TO INSERTS THAT ARE DRIVEN IN. NOT ONLY ARE THEY ECONOMICAL TO BUY, THEY ALSO SAVE LABOR COSTS DURING INSTALLATION.

| PART NUMBER        | SIZE           | L | PD    | FD   | QTY./CTN | WT./M |
|--------------------|----------------|---|-------|------|----------|-------|
| INSA-SC08-M10-Z-CZ | 8-32 X 10 MM   |   | .236" | .315 | 50,000   | 1.8   |
| INSA-SF10-M10-Z-CZ | 10-32 X 10 MM  |   | .295" | .394 | 25,000   | 2.2   |
| INSA-FC04-M10-Z-CZ | 1/4-20 X 10 MM |   | .354" | .465 | 20,000   | 4.0   |
| INSA-FC04-M13-Z-CZ | 1/4-20 X 13 MM |   | .354" | .465 | 15,000   | 6.0   |

PLEASE NOTE OTHER SIZES AVAILABLE UPON REQUEST. PLEASE FEEL FREE TO INQUIRE.

04/04/03

**TOLL FREE PH 1-888-551-0456 FAX 1-888-551-0454**

**WWW.TITANHARDWARE.COM**

**003-001**



**TITAN**  
**HARDWARE INTERNATIONAL**  
 7711 AMIGOS AVE, SUITE C, DOWNEY, CA 90242  
 LOCAL PH 562-803-1695 FAX 562-803-6605  
 EMAIL SALES@TITANHARDWARE.COM

# TYPE "B" INSERT

## (KNOCK IN)

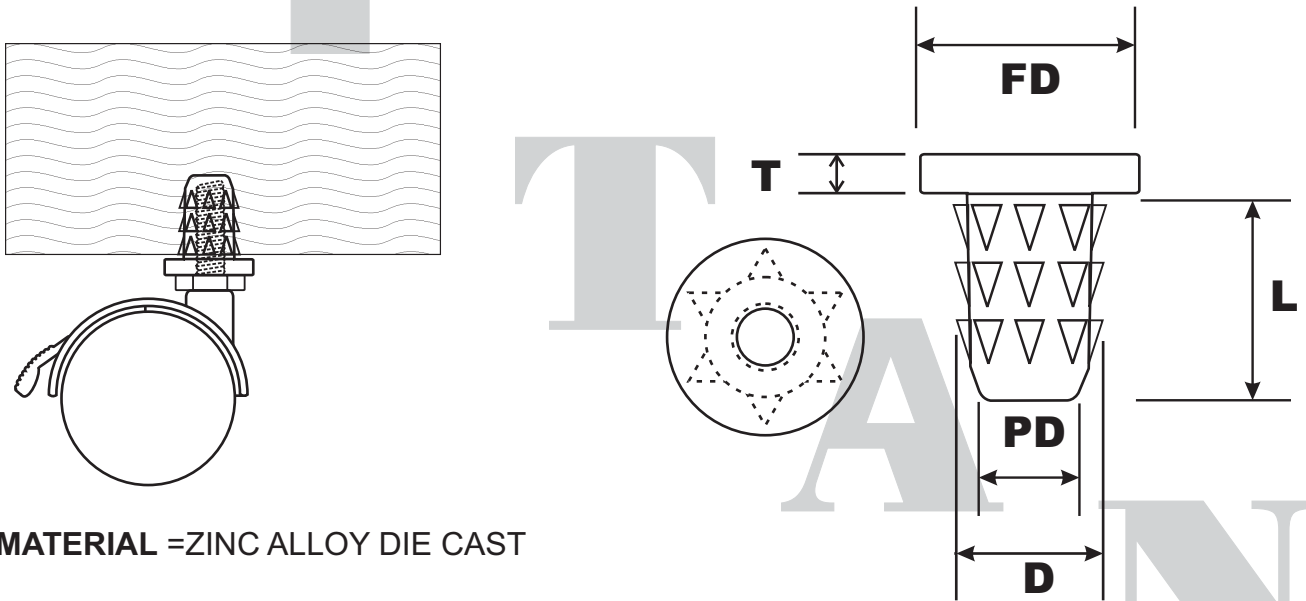

**MATERIAL** =ZINC ALLOY DIE CAST

**TYPE "B" INSERTS** ARE THE HIGH QUALITY- LOW COST ALTERNATIVE TO INSERTS THAT ARE DRIVEN IN. NOT ONLY ARE THEY ECONOMICAL TO BUY, THEY ALSO SAVE LABOR COSTS DURING INSTALLATION. THEY ARE NORMALLY USED ANYWHERE YOU WOULD USE A T-NUT.

| TITAN P#            | SIZE    | L (MM) | FD"   | D"    | PD"   | T"    | Q'TY/CTN |
|---------------------|---------|--------|-------|-------|-------|-------|----------|
| INSB-SC08-08-Z-CZ   | 8-32    | 8.1    | 0.262 | 0.193 | 0.152 | 0.036 | 15,000   |
| INSB-SC10-08.5-Z-CZ | 10-24   | 8.5    | 0.318 | 0.249 | 0.173 | 0.056 | 10,000   |
| INSB-SF10-08.5-Z-CZ | 10-32   | 8.5    | 0.318 | 0.249 | 0.173 | 0.056 | 10,000   |
| INSB-FC04-08.5-Z-CZ | 1/4-20  | 8.5    | 0.409 | 0.297 | 0.234 | 0.051 | 6,000    |
| INSB-FC04-10.3-Z-CZ | 1/4-20  | 10.3   | 0.358 | 0.279 | 0.203 | 0.051 | 6,000    |
| INSB-FC04-12.9-Z-CZ | 1/4-20  | 12.9   | 0.366 | 0.295 | 0.229 | 0.036 | 6,000    |
| INSB-FC04-13-Z-CZ   | 1/4-20  | 13.0   | 0.368 | 0.295 | 0.229 | 0.064 | 6,000    |
| INSB-FC05-11.5-Z-CZ | 5/16-18 | 11.5   | 0.478 | 0.323 | 0.254 | 0.051 | 5,000    |
| INSB-FC05-13.6-Z-CZ | 5/16-18 | 13.6   | 0.478 | 0.318 | 0.254 | 0.043 | 4,000    |
| INSB-FC05-21.6-Z-CZ | 5/16-18 | 21.6   | 0.483 | 0.323 | 0.254 | 0.028 | 4,000    |
| INSB-FC06-14.4-Z-CZ | 3/8-16  | 14.4   | 0.513 | 0.363 | 0.295 | 0.041 | 4,000    |

PLEASE NOTE OTHER SIZES AVAILABLE UPON REQUEST. PLEASE FEEL FREE TO INQUIRE.

04/04/03

**TOLL FREE PH 1-888-551-0456 FAX 1-888-551-0454**

**WWW.TITANHARDWARE.COM**

**003-002**



# TITAN HARDWARE INTERNATIONAL

7711 AMIGOS AVE, SUITE C, DOWNEY, CA 90242  
 LOCAL PH 562-803-1695 FAX 562-803-6605  
 EMAIL SALES@TITANHARDWARE.COM

## TYPE "D" INSERT

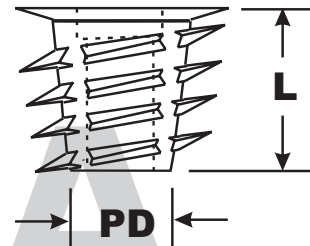
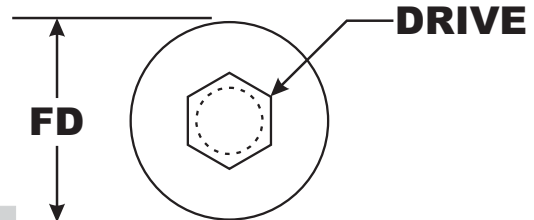
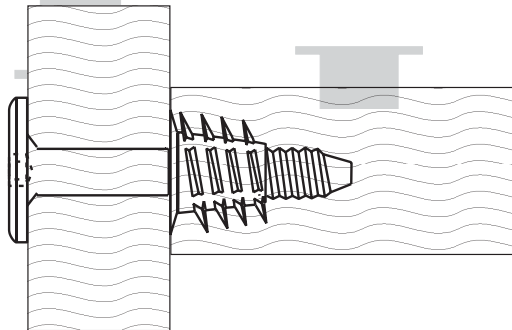

**MATERIAL** =ZINC ALLOY DIE CAST

**TYPE "D" INSERTS** ARE THE HIGH QUALITY LOW COST ALTERNATIVE TO MACHINED STEEL OR BRASS INSERTS FOR WOOD. SHARP NOTCHED THREADS FORM A POSITIVE HIGH TORQUE BOND TO A WIDE RANGE OF MATERIALS. FEATURES INCLUDE A HIGH TORQUE HEX DRIVE, AND A FLUSH MOUNT HEAD. FOR PROPER ALIGNMENT AND DEPTH CONTROL.

| PART NUMBER        | SIZE           | L | PD    | FD   | DRIVE | QTY./CTN | WT./M |
|--------------------|----------------|---|-------|------|-------|----------|-------|
| INSD-SC10-M10-Z-CZ | 10-24 X 10 MM  |   | .260" | .445 | M5    | 13,000   | 4.7   |
| INSD-SF10-M10-Z-CZ | 10-32 X 10 MM  |   | .260" | .445 | M5    | 13,000   | 4.7   |
| INSD-SC10-M13-Z-CZ | 10-24 X 13 MM  |   | .260" | .445 | M5    | 12,000   | 5.0   |
| INSD-SF10-M13-Z-CZ | 10-32 X 13 MM  |   | .260" | .445 | M5    | 12,000   | 5.0   |
| INSD-FC04-M10-Z-CZ | 1/4-20 X 10 MM |   | .293" | .492 | M6    | 13,000   | 5.0   |
| INSD-FC04-M13-Z-CZ | 1/4-20 X 13 MM |   | .293" | .492 | M6    | 10,000   | 5.2   |
| INSD-FC04-M20-Z-CZ | 1/4-20 X 20 MM |   | .293" | .492 | M6    | 7,500    | 8.7   |
| INSD-FC04-M25-Z-CZ | 1/4-20 X 25 MM |   | .293" | .492 | M6    | 5,000    | 12.8  |
| INSD-FC05-M13-Z-CZ | 5/16-18 X 13MM |   | .374" | .571 | M8    | 6,500    | 8.9   |
| INSD-FC05-M25-Z-CZ | 5/16-18 X 25MM |   | .374" | .571 | M10   | 4,000    | 15.3  |
| INSD-FC06-M25-Z-CZ | 3/8-16 X 25MM  |   | .460" | .625 | M10   | 3,000    | 21.0  |

PLEASE NOTE OTHER SIZES AVAILABLE UPON REQUEST. PLEASE FEEL FREE TO INQUIRE.

12/15/99 **TOLL FREE PH 1-888-551-0456 FAX 1-888-551-0454**

**WWW.TITANHARDWARE.COM**

**003-003**



**TITAN**  
**HARDWARE INTERNATIONAL**  
 7711 AMIGOS AVE, SUITE C, DOWNEY, CA 90242  
 LOCAL PH 562-803-1695 FAX 562-803-6605  
 EMAIL SALES@TITANHARDWARE.COM

# ULTRASERT

TM

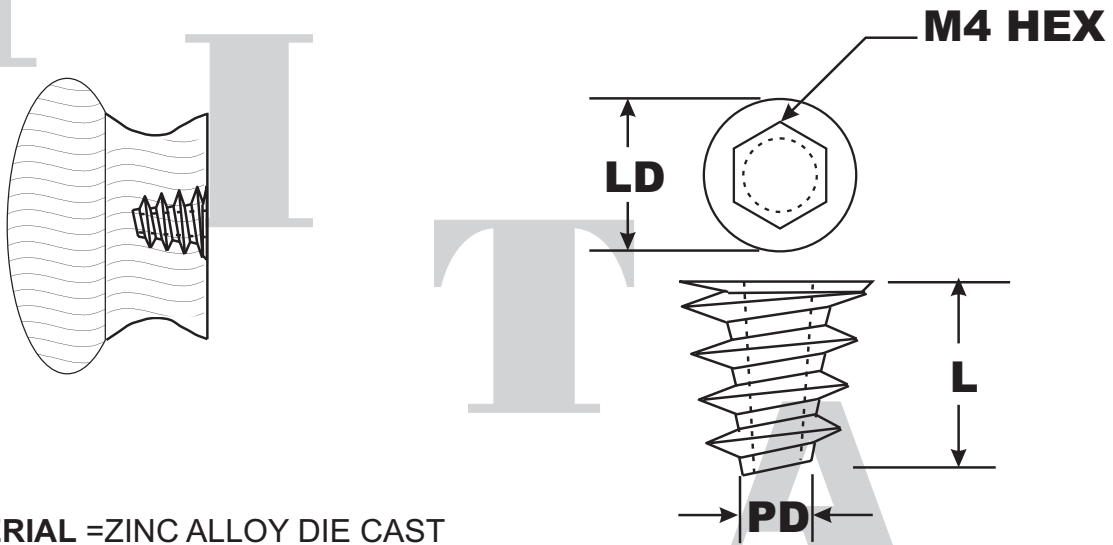

**MATERIAL** =ZINC ALLOY DIE CAST

**ULTRASERT** INSERTS ARE THE HIGH QUALITY LOW COST ALTERNATIVE TO MACHINED STEEL OR BRASS INSERTS FOR WOOD OR PLASTICS. FEATURES INCLUDE A SPECIALLY DESIGNED THREAD, SHARP ENOUGH TO CUT INTO HARD MATERIALS YET WIDE ENOUGH TO HOLD IN SOFT MATERIALS. THEY ALSO COME WITH A HEX DRIVE FOR EASY INSTALLATION

| PART NUMBER        | SIZE         | L | PD    | LD    | QUANTITY PER CTN | WEIGHT PER M |
|--------------------|--------------|---|-------|-------|------------------|--------------|
| INSU-SC08-M10-Z-CZ | 8-32 X 10 MM |   | .195" | .310" | 10,000           | 2.34         |

PLEASE NOTE OTHER SIZES AVAILABLE UPON REQUEST. PLEASE FEEL FREE TO INQUIRE.

12/15/99 **TOLL FREE PH 1-888-551-0456 FAX 1-888-551-0454**

**WWW.TITANHARDWARE.COM**

**003-004**



# TITAN HARDWARE INTERNATIONAL

7711 AMIGOS AVE, SUITE C, DOWNEY, CA 90242  
 LOCAL PH 562-803-1695 FAX 562-803-6605  
 EMAIL SALES@TITANHARDWARE.COM

## TYPE "E" INSERT

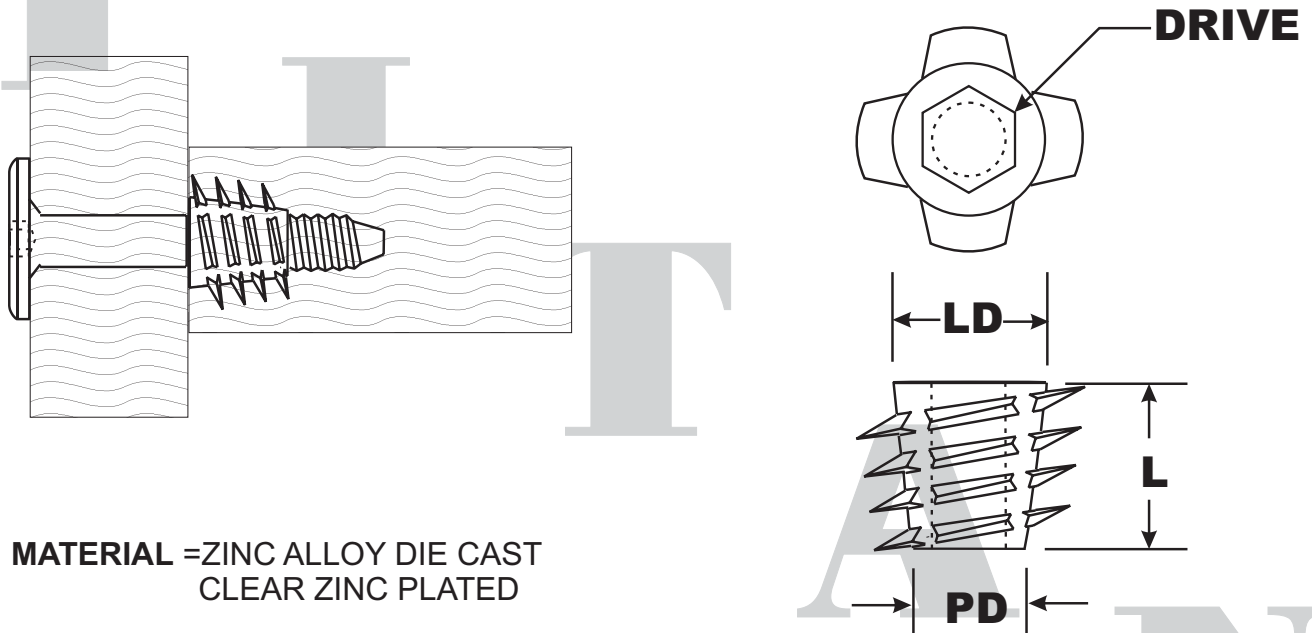

**MATERIAL** =ZINC ALLOY DIE CAST  
 CLEAR ZINC PLATED

**TYPE "E" INSERTS** ARE THE HIGH QUALITY LOW COST ALTERNATIVE TO MACHINED STEEL OR BRASS INSERTS FOR WOOD. SHARP NOTCHED THREADS FORM A POSITIVE, HIGH TORQUE BOND TO A WIDE RANGE OF MATERIALS. FEATURES INCLUDE A HIGH TORQUE HEX DRIVE.

| PART NUMBER        | SIZE           | L     | PD    | LD | DRIVE  | QTY./CTN | WT./M |
|--------------------|----------------|-------|-------|----|--------|----------|-------|
| INSE-SC06-M10-Z-CZ | 6-32 X 10 MM   | .197" | .215" | M3 | 30,000 | 2.1      |       |
| INSE-SC08-M10-Z-CZ | 8-32 X 10 MM   | .217" | .235" | M4 | 30,000 | 3        |       |
| INSE-SC10-M13-Z-CZ | 10-24 X 13 MM  | .264" | .310" | M5 | 12,000 | 6        |       |
| INSE-SF10-M13-Z-CZ | 10-32 X 13 MM  | .264" | .310" | M5 | 12,000 | 6        |       |
| INSE-FC04-M13-Z-CZ | 1/4-20 X 13 MM | .299" | .340" | M6 | 13,000 | 4.8      |       |
| INSE-FC04-M20-Z-CZ | 1/4-20 X 20 MM | .299" | .340" | M6 | 8,000  | 7.9      |       |
| INSE-FC05-M13-Z-CZ | 5/16-18 X 13MM | .413" | .512" | M8 | 6,000  | 10       |       |
| INSE-FC05-M20-Z-CZ | 5/16-18 X 20MM | .413" | .787" | M8 | 3,000  | 16       |       |
| INSE-FC05-M25-Z-CZ | 5/16-18 X 25MM | .413" | .563" | M8 | 4,000  | 20       |       |

PLEASE NOTE OTHER SIZES AVAILABLE UPON REQUEST. PLEASE FEEL FREE TO INQUIRE.

10/23/01 **TOLL FREE PH 1-888-551-0456 FAX 1-888-551-0454**

**WWW.TITANHARDWARE.COM**

**003-005**



**TITAN**  
**HARDWARE INTERNATIONAL**  
 7711 AMIGOS AVE, SUITE C, DOWNEY, CA 90242  
 LOCAL PH 562-803-1695 FAX 562-803-6605  
 EMAIL SALES@TITANHARDWARE.COM

# TYPE "I" INSERT

## (KNOCK IN)

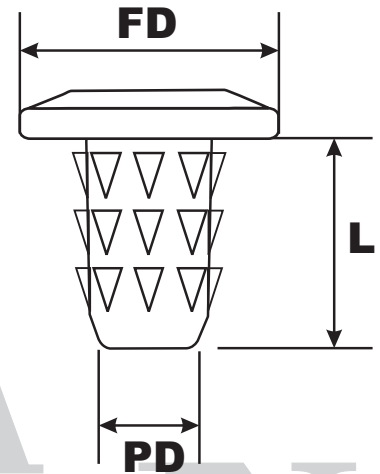
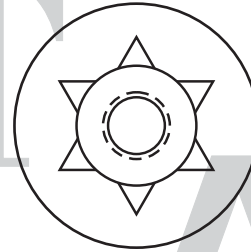
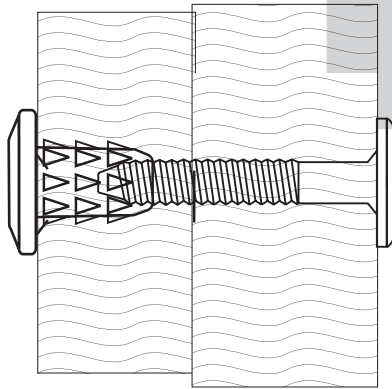

**MATERIAL =ZINC ALLOY DIE CAST**

**TYPE "I" INSERTS** ARE THE HIGH QUALITY LOW COST ALTERNATIVE TO JCB CAP NUTS. THEY ARE USED IN SITUATIONS WHERE YOU WOULD WANT TO SANDWICH TWO ITEMS TOGETHER. THEY ARE ALSO FAST AND EASY TO INSTALL.

| PART NUMBER        | SIZE           | L | PD    | FD   | QTY./CTN | WT./M |
|--------------------|----------------|---|-------|------|----------|-------|
| INSI-SC08-M10-Z-CZ | 8-32 X 10 MM   |   | .215" | .435 | 5,000    | 4.7   |
| INSI-SC10-M10-Z-CZ | 10-24 X 10 MM  |   | .215" | .435 | 5,000    | 4.7   |
| INSI-FC04-M15-Z-CZ | 1/4-20 X 15 MM |   | .310" | .664 | 5,000    | 13.0  |

PLEASE NOTE OTHER SIZES AVAILABLE UPON REQUEST. PLEASE FEEL FREE TO INQUIRE.

01/23/02

**TOLL FREE PH 1-888-551-0456 FAX 1-888-551-0454**

**WWW.TITANHARDWARE.COM**

**003-006**



**TITAN**  
**HARDWARE INTERNATIONAL**  
 7711 AMIGOS AVE, SUITE C, DOWNEY, CA 90242  
 LOCAL PH 562-803-1695 FAX 562-803-6605  
 EMAIL SALES@TITANHARDWARE.COM

# TYPE "SKH" INSERT

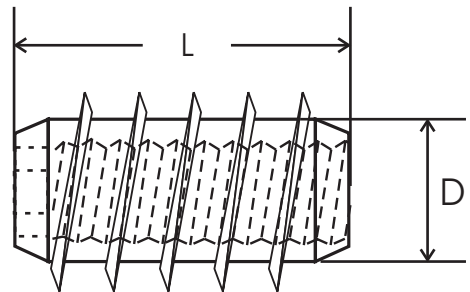
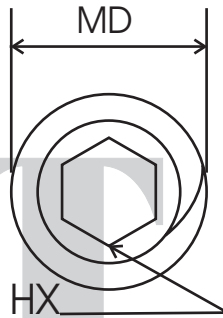
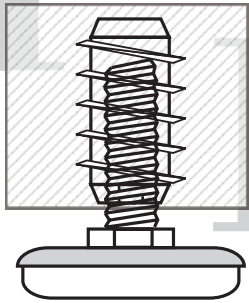

**SKH INSERTS** OFFER A COURSE DEEP THREAD FOR EXTRA HOLDING POWER, A HEX DRIVE FOR A POSITIVE WOBBLE FREE INSTALLATION. AND ARE MADE OF LOW CARBON STEEL FOR UNSURPASSED STRENGTH OF ANY INSERT WE CARRY.

| PART NUMBER          | SIZE                    | L      | D      | MD   | HX    | QTY./CTN | WT./M |
|----------------------|-------------------------|--------|--------|------|-------|----------|-------|
| INSKH-FC04-M015-S-CZ | 1/4-20 X 15MM (0.591")  | 0.374" | 0.472" | 6MM  | 3,000 | 14       |       |
| INSKH-FC04-M020-S-CZ | 1/4-20 X 20MM (0.787")  | 0.374" | 0.472" | 6MM  | 2,500 | 18       |       |
| INSKH-FC05-M018-S-CZ | 5/16-18 X 18MM (0.709") | 0.453" | 0.552" | 8MM  | 1,400 | 20       |       |
| INSKH-FC05-M030-S-CZ | 5/16-18 X 30MM (1.181") | 0.528" | 0.630" | 8MM  | 800   | 58       |       |
| INSKH-FC06-M030-S-CZ | 3/8-16 X 30MM (1.181")  | 0.618" | 0.728" | 10MM | 500   | 69       |       |



# TITAN HARDWARE INTERNATIONAL

7711 AMIGOS AVE, SUITE C, DOWNEY, CA 90242  
 LOCAL PH 562-803-1695 FAX 562-803-6605  
 EMAIL SALES@TITANHARDWARE.COM

## KNIFE THREAD INSERTS

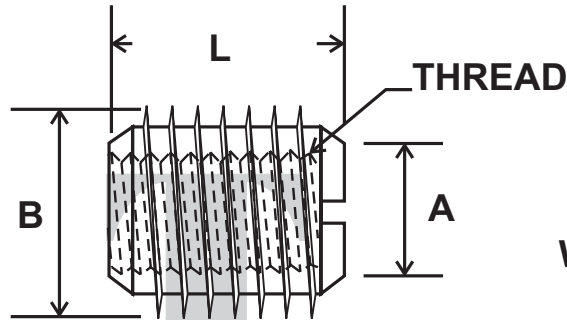
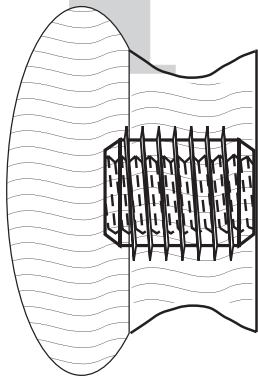

WITH SLOT

**MATERIAL;  
 LOW CARBON STEEL  
 BRASS  
 STAINLESS**

**KNIFE THREAD INSERTS** ARE USED WHEN EXTRA STRENGTH IS REQUIRED, SUCH AS IN HARD WOODS. THE SHARP OUTER THREADS CUT THROUGH THE GRAIN AND THUS REDUCE THE CHANGE OF SPLITTING THE WOOD.

| PART NUMBER       | THREAD X L     | A    | B     | QTY./CTN |
|-------------------|----------------|------|-------|----------|
| INSK-SC04-06-S-YZ | 4-40 X 3/8"    | 1/4" | 21/64 | 1,000    |
| INSK-SC06-06-S-YZ | 6-32 X 3/8"    | 1/4" | 21/64 | 1,000    |
| INSK-SC08-06-S-YZ | 8-32 X 3/8"    | 1/4" | 21/64 | 1,000    |
| INSK-SC10-08-S-YZ | 10-24 X 1/2"   | 3/8" | 29/64 | 1,000    |
| INSK-SF10-08-S-YZ | 10-32 X 1/2"   | 3/8" | 29/64 | 1,000    |
| INSK-FC04-08-S-YZ | 1/4-20 X 1/2"  | 3/8" | 29/64 | 1,000    |
| INSK-FC05-08-S-YZ | 5/16-18 X 1/2" | 1/2" | 19/32 | 1,000    |
| INSK-FC06-08-S-YZ | 3/8-16 X 1/2"  | 1/2" | 19/32 | 1,000    |
| INSK-FC08-08-S-YZ | 1/2-13 X 1/2"  | 1/2" | 19/32 | 1,000    |

PLEASE NOTE OTHER SIZES AVAILABLE UPON REQUEST. PLEASE FEEL FREE TO INQUIRE.

01/07/02 **TOLL FREE PH 1-888-551-0456 FAX 1-888-551-0454**

**WWW.TITANHARDWARE.COM**

**003-008**